

AIR SKATES

Aero-Casters® “Float” Heavy Loads On Air

Air casters or air bearings provide a clean, quiet and safe alternative to moving heavy loads. AeroGo® Aero-Casters are designed to literally float loads from 500 lbs. to over 5000 tons on a virtually frictionless film of air. Aero-Casters use pneumatic components such as air regulators and hose, resulting in reliable products that operate in a safe, clean, and ergonomic manner in most environments including cleanrooms.

How Aero-Casters Work: An air film is created by compressed air pumped into the circular air caster diaphragm and center plenum chamber. When the air pressure in the air caster exceeds the weight of the load, air slowly and evenly escapes between the flexible diaphragm and the surface to create a thin, nearly frictionless film of air .003 to .005 inches thick. The load is virtually floating over the floor surface.

Aero-Caster Benefits: Reduced friction and omnidirectional movement allow the operator to precisely place and align the load in a limited workspace. The low profile of the air caster load module requires less than 3-inch clearance. Air casters will not damage floors and expensive reinforcement is usually not necessary, even when moving 5,000 tons.

ISO Certified: Since 1967, AeroGo has been the premiere manufacturer of air caster products. AeroGo is ISO certified by ABS Quality Evaluations, Inc and complies with SAE AS9003: 2001 and ISO 9001:2000 quality standards.

Aero-Caster® Load Module Assembly

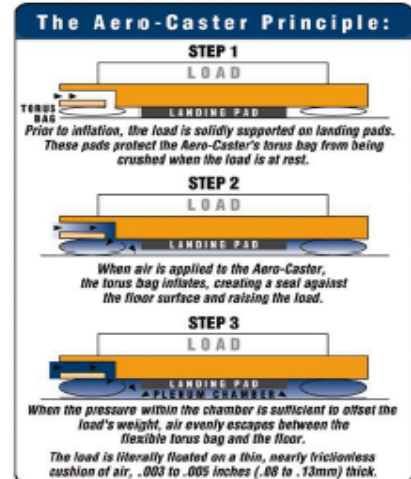
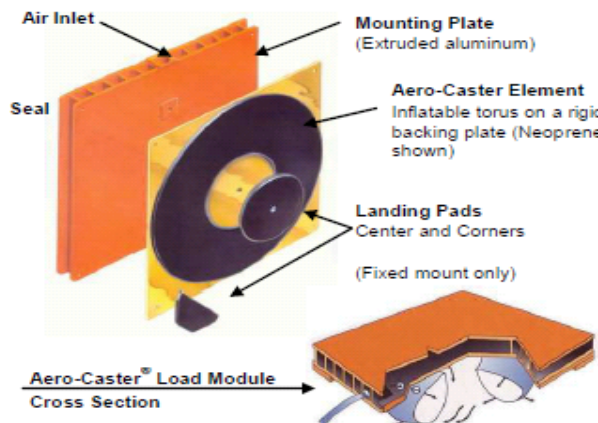

Aero-Caster® Models

Neoprene

- Used in over 80% of applications
- The standard of the industry since 1967
- Low pressure and low-load applications
- Heavy Duty neoprene also available

Urethane

- Provides superior resistance to abrasion
- Reinforced with a special seal coating
- For frequent or long moves, rough floors, dust/debris areas

DuraGlide™

- Provides lower lift than other materials
- Perfect for high travel areas
- For surfaces difficult to keep clear of dirt or debris

Gapmaster™

- Allows loads to cross gaps, steps or move over slightly porous surfaces



LIFTING & RIGGING EQUIPMENT FOR ALL LIFTING APPLICATIONS

- ✓ Hoisting Equipment
- ✓ Spreader Beams
- ✓ Winching Equipment
- ✓ Jacking Systems
- ✓ Lifting Equipment
- ✓ Weighing & Testing
- ✓ Lifting Slings
- ✓ Height Safety Gear

CALL US (08) 9494 1861 VISIT RIGGINGRENTALS.COM.AU

AIR SKATES



NEOPRENE HEAVY DUTY FOUR LOAD MODULE SYSTEMS / AIR CASTER RIGGING SYSTEMS



Part#	Model	Part#	Model	Capacity (lbs)	Air Flow++ (SCFM)	Control Console	Net Weight (lbs)++
33206	4K8NHDL	33216	4K8NHDSML	8,000	48	BN34	60
33227	4K12NHDL	33238	4K12NHDSML	20,000	64	BN34	85
33249	4K15NHDL	33260	4K15NHDSML	34,000	80	BN64	125
33271	4K21NHDL	33282	4K21NHDSML	64,000	100	BN64	185
33292	4K27NHDL	33302	4K27NHDSML	112,000	192	BN84	315
33312	4K36NHDL	33322	4K36NHDSML	200,000	216	BN84	480
33332	4K48NHDL	33342	4K48NHDSML	360,000	240	BN84	820

NEOPRENE HEAVY DUTY SIX LOAD MODULE SYSTEMS / AIR CASTER RIGGING SYSTEMS



Part#	Model	Part#	Model	Capacity (lbs)	Air Flow++ (SCFM)	Control Console	Net Weight (lbs)++
33406	6K8NHDL	33416	6K8NHDSML	12,000	72	BN66	105
33427	6K12NHDL	33438	6K12NHDSML	30,000	96	BN66	140
33449	6K15NHDL	33460	6K15NHDSML	51,000	120	BN66	185
33471	6K21NHDL	33482	6K21NHDSML	96,000	150	BN66	270
33492	6K27NHDL	33502	6K27NHDSML	168,000	288	BN86	460
33512	6K36NHDL	33522	6K36NHDSML	300,000	324	BN86	710
33532	6K48NHDL	33542	6K48NHDSML	540,000	360	BN86	1,220

+ Net weight based on Slide-Mount Systems

Each Load Module System Includes:

Four or Six Load Modules with quick disconnect (QD) adapters

Four or Six 20 foot long color coded interconnection hoses with quick disconnect (QD) coupler (both ends)

Four or Six station regulator control console with four or six quick disconnect (QD) adapter outlets and one on/off valve at the inlet.

* All Slide-Mount Systems also include an Aero-Caster removal tool.

- Supply hose and quick disconnect couplers available at an additional cost.

++ NOTE ON ESTIMATED AIR FLOW - Air flow listed on this page is an estimate of the air flow at a given load, and a good operating surface. Always multiply this air flow data times 1.75 (1.5 for Gapmaster) to provide a safety factor; when providing data to a customer; or when calculating air compressor requirements.

LIFTING & RIGGING EQUIPMENT FOR ALL LIFTING APPLICATIONS

- ✓ Hoisting Equipment
- ✓ Spreader Beams
- ✓ Winching Equipment
- ✓ Jacking Systems
- ✓ Lifting Equipment
- ✓ Weighing & Testing
- ✓ Lifting Slings
- ✓ Height Safety Gear

CALL US (08) 9494 1861 VISIT RIGGINGRENTALS.COM.AU